

0 0.25 0.5  
Miles

1 INCH EQUALS 0.25 MILES

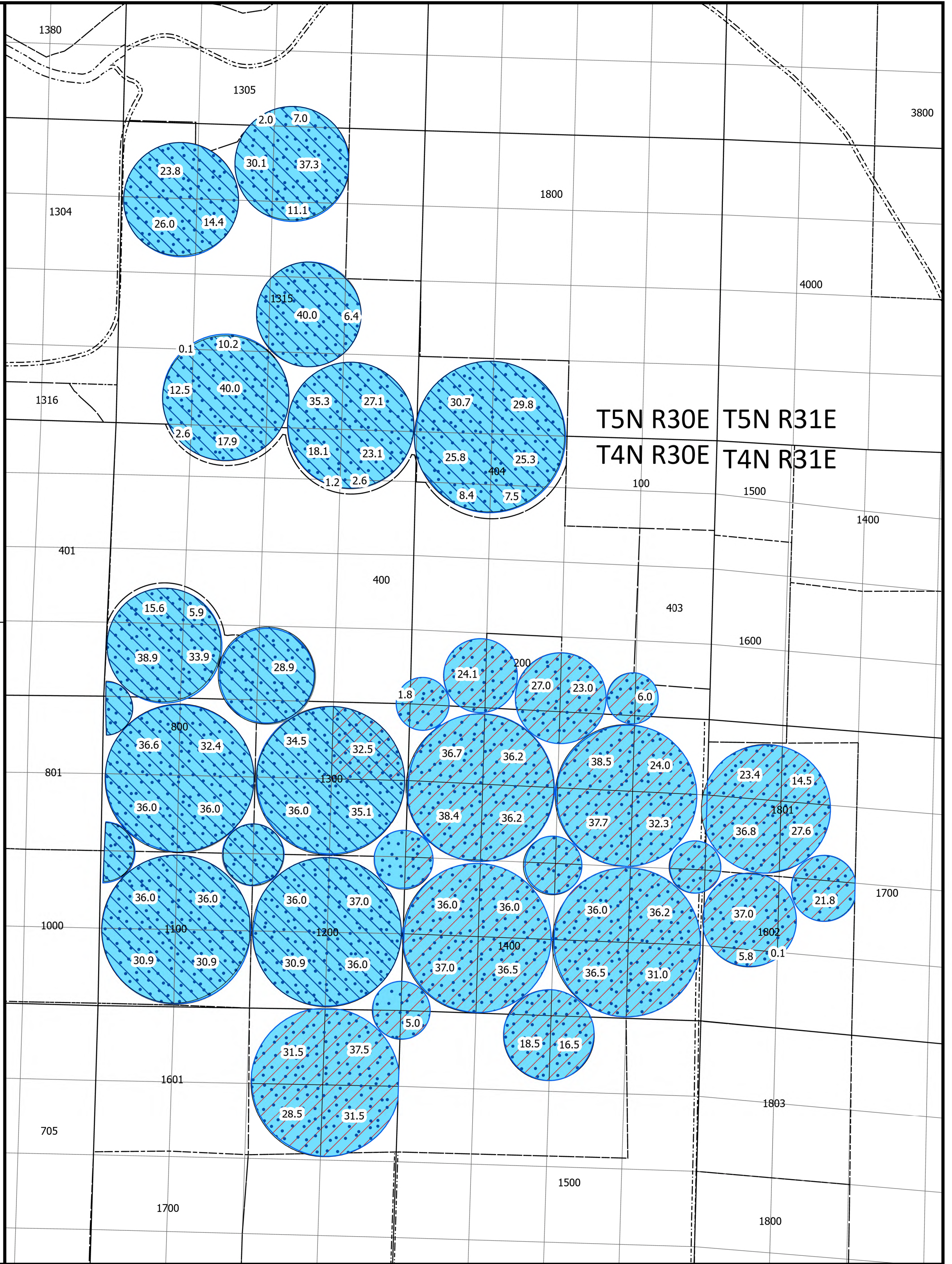

TOWNSHIP 4N 30E, 4N 31E, 5N 30E, W.M.

MID COLUMBIA WATER COMMISSION

2024 PLANNED WATER USE

Permits S-55114, S-55167 S-55262, S-55263

COLD SPRINGS CANYON

Legend

■ EID Point of Diversion

■ EID POD

--- EID Pipeline

Underlying Water Rights

▨ Permit: S 55127 \* IR, CW 63, CW 64, CW 65

▨ Permit: S 55340 \* IR

▨ CW-64, CW-98

MCWC Planned Use 2024

■ Primary

Projection: UTM Zone 11  
Datum: NAD 1983  
Date : January 2024.  
Data Sources: OWRD; PLS; CSC; IRZ; Umatilla County GIS

*This map was prepared for the purpose of identifying the location of the water rights only and it is not intended to provide legal dimension or locations of property ownership lines.*



Date Saved: 2/8/2024 11:40 AM